

| Rev. | Date |
|------|----------|
| A1 | 04/04/08 |
| A2 | 13/11/08 |
| A3 | 17/11/09 |
| | |

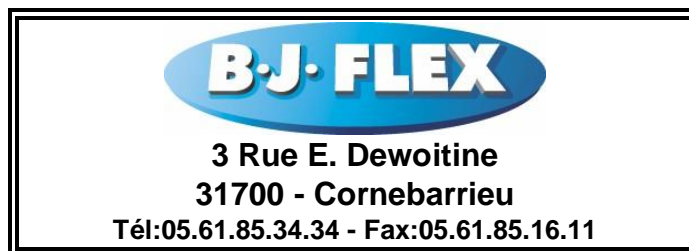

JS 12

<<2 STRIES>>

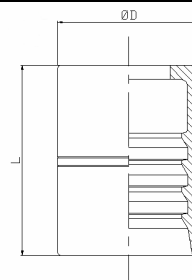

Mise à jour permanente de ces fiches sur le site :
www.bjflex.com

Tolérance : Dénudage externe : +1 / - 0.5
 Sertissage : 0 / - 0.3

| Ø tuyau | type jupe Ø X long | Paramètres de sertissage | TYPE TUYAU | | | | | | | | | | | | | | | |
|---------------------------|-----------------------|--------------------------------|------------|------------|--------|------|------|------------|--------------|--------------|--------------|------------|------------|------------|--------------|--------------------|--------------|--------------------|
| | | | R5 | Vap2T | Curage | 1 SC | 1SNK | R1A | R1AT | 2 SC | 2SNK | R2A | R2AT | ASPI | EPD M | T2/T3 | | |
| DN 6 1/4" MOD 4 | JS 12 06 Ø20x28.5 | Lg dénudage Ø sertis | | 20 17.0 | | | | 20 16.5 | Sans 17.0 | Sans 18.0 | Sans 17.8 | 20 17.1 | 20 17.2 | | | T2 Sans 16.8 | | |
| DN 8 5/16" MOD 5 | JS 12 08 Ø22x28.5 | Lg dénudage Ø sertis | | 20 18.3 | | | | 20 18. | Sans 19.0 | Sans 19.0 | Sans 19.1 | 20 18.7 | 20 18.6 | | | T2 Sans 18.2 | | |
| DN 10 3/8" MOD 6 | JS 12 10 Ø25x33.5 | Lg dénudage Ø sertis | | 24 21.3 | | | | 24 20.6 | Sans 21.5 | Sans 21.9 | Sans 22.2 | 24 21.3 | 24 22.2 | | | Sans 22.5 | | |
| DN 12 1/2" MOD 8 | JS 12 13 Ø29x35.5 | Lg dénudage Ø sertis | Sans | 26 27.2 | | | | 26 23.5 | Sans 24.8 | Sans 25.0 | Sans 25.8 | 26 24.6 | 26 25.3 | | Sans 25.4 | T2 Sans 24.1 | | |
| DN 16 5/8" MOD 10 | JS 12 16 Ø32x39.5 | Lg dénudage Ø sertis | | | | Sans | Sans | 28 27.7 | Sans 28.2 | 28 27.1 | 28 28 | 28 29.1 | 28 28.8 | | | | | |
| DN 19 3/4" MOD 12 | JS 12 19 Ø36x41.5 | Lg dénudage Ø sertis | | | | Sans | Sans | 30 31.2 | Sans 31.7 | 30 31.5 | 30 31.9 | 30 32.0 | 30 31.9 | 30 32.7 | 30 31.7 | Sans 33.5 | Sans 33. | Sans 34. |
| DN 25 1" MOD 16 | JS 12 25 Ø44x45.5 | Lg dénudage Ø sertis | | | 33 | Sans | Sans | 32 38.5 | Sans 38.5 | 32 38.9 | 32 38.4 | 32 39.5 | 32 39.5 | 32 39.1 | 32 38.4 | 32 39.4 | Sans 38.4 | Sans 40.5 |
| DN 31 1 1/4" MOD 20 | JS 12 32 Ø55x51.5 | Lg dénudage Ø sertis | | | | | Sans | 38 48.4 | Sans 48.0 | | | | | 38 50.5 | 38 48.0 | Sans 46.0 | Sans 52. | T3 Sans 49.5 |
| DN 38 1 1/2" MOD 24 | JS 12 38 Ø 62X 58 | Lg dénudage Ø sertis | | | | | | 44 54.6 | Sans 55.0 | | | | | 44 55.6 | 44 55.7 | Sans 56 | Sans 54.2 | T3 Sans 54.5 |
| DN 51 2" MOD 32 | JS 12 50 Ø 75X 64 | Lg dénudage Ø sertis | | | | | | 47 68.4 | Sans 68.1 | | | | | 47 68.7 | 47 67.5 | Sans 65.0 | Sans 69.5 | T3 Sans 71.0 |

**ATTENTION : VALEURS DONNEES A TITRE INDICATIF. CONTROLE A LA PIGE DE LA DEFORMATION DU NIPPLE.
 (SAUF R4 / T3)**